

# WHEN EVERY MINUTE COUNTS

## Inova Loudoun Hospital Emergency Room expands level of care

**W**hen emergency strikes, it's nice to know there's a beacon of light close to home — a place that you trust, where you can receive high-quality, advanced medical care for even the most serious of conditions.

In an effort to provide the highest level of emergency care in the community, the Inova Loudoun Hospital (ILH) Emergency Room (ER) at Lansdowne is pursuing Level III Trauma designation and expanding — both in its scope of services and size — to meet the county's ever-growing needs. "Over the last 10 years, we have been steadily expanding our services and facilities at Inova Loudoun Hospital to accommodate the

growing population," says H. Patrick Walters, CEO of ILH. "As an advanced community hospital providing cutting-edge technology and medicine, we want to ensure that our community is receiving the best, most up-to-date quality care they deserve and need."

The Level III Trauma designation and ER expansion at Lansdowne will further help ILH fulfill its mission. "These additional services will have an impact

on patient outcomes — faster treatment and better recovery with family and friends nearby," says Edward Puccio, MD, FACEP, Chairman and Medical Director of the Emergency Department at ILH.

### CARING FOR THE COMMUNITY

Slated for completion in 2018, the ER expansion will yield eight new private treatment bays with state-of-the-art technology and equipment — bringing

the total number of rooms to 34. The expanded ER will also be supported by three new significantly larger operating rooms for the trauma program, a remodeled nurses' station, and enhanced and expanded intensive care unit (ICU) capabilities.

As the hospital continues to grow, the ER will also expand its specialized team of board-certified emergency physicians and dedicated emergency

nurses. There will be other hospital campus expansions including the Inova Heart and Vascular Institute - Schauffel Family Heart Center and a new patient tower. An estimated 250 more staff members will be added to the team in the next three to five years to help meet the needs of the hospital and community.

### NEW TRAUMA DESIGNATION

As ILH works toward achieving a Level III Trauma designation, there will not be any interruption of care for patients.

"The Level III designation will allow people to get their care closer to home," says B. Jill McCabe, MD, FAAP, President



The brick-breaking ceremony for the upcoming Inova Virts Miller Family Emergency and Trauma Center took place in September 2016.

### Giving Back

It was in May 2015 when Sharon Virts' brother, Kevin, was rushed to the Inova Emergency Room (ER) - Leesburg with a brain aneurysm. Grateful for the expert, compassionate care Kevin received, Sharon and her husband, Scott Miller, committed \$2 million to support the growth of the Inova Loudoun Hospital ER and catalyze the development of advanced clinical and trauma services. The new ER will be named the Inova Virts Miller Family Emergency and Trauma Center.

"My entire family will be forever grateful to the amazing Inova doctors, nurses, administrators and every single person who helped my brother not only survive — but thrive," says Sharon. "For this reason, Scott and I chose to support the hospital's need for greater capabilities, enhanced treatments and leading-edge techniques that will significantly benefit our wonderful community."

A Loudoun County native, Sharon notes that, "Loudoun County is our home. We have been richly blessed by this community. Scott and I hope that our gift will ensure that local access to world-class healthcare is available to everyone here in Loudoun — where it is needed and where it belongs. We know that families just like ours go through the ER every day. We want to help ensure that they experience the same positive outcomes as we did."

# Inova Virts Miller Family Emergency and Trauma Center

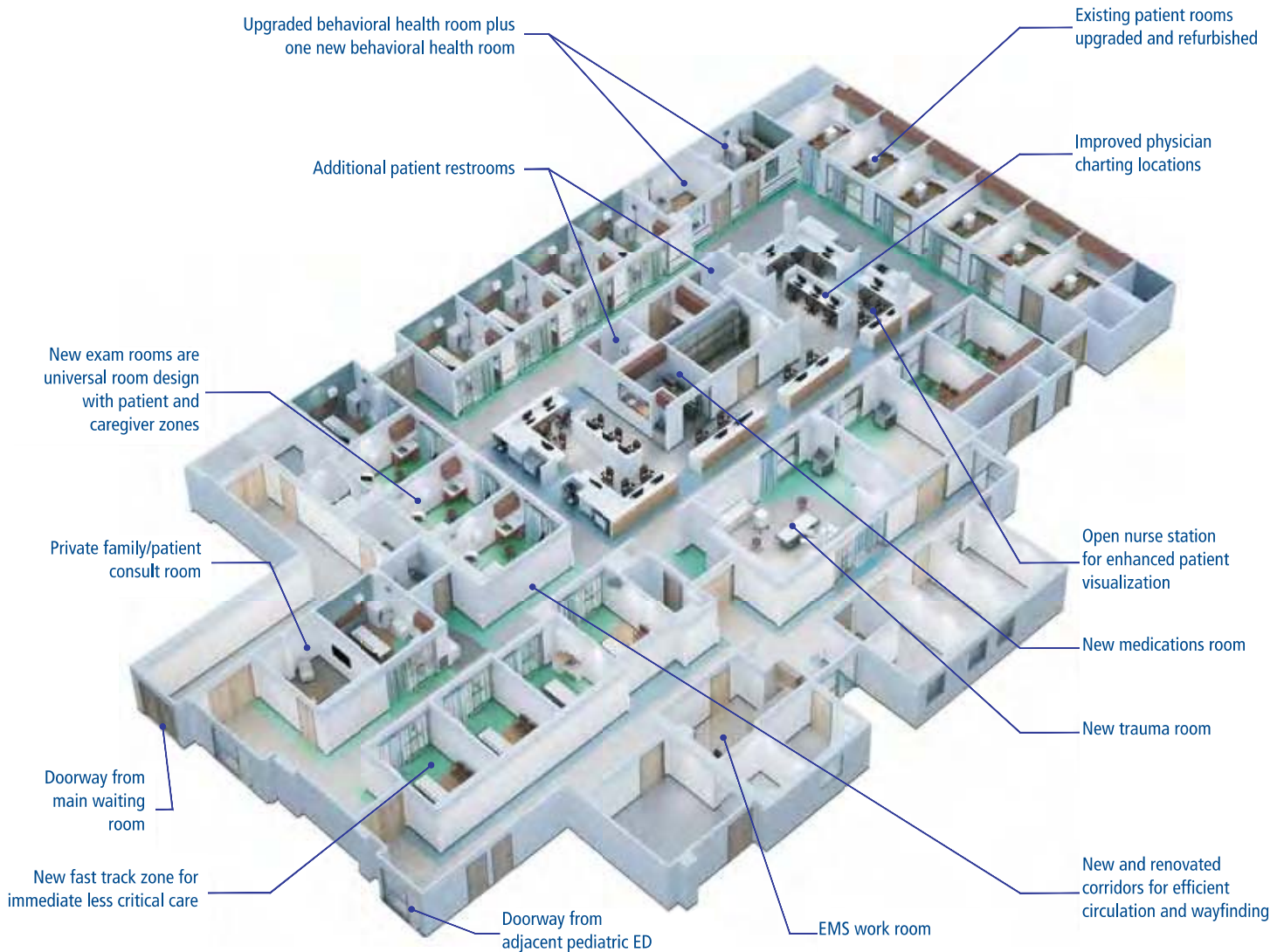

of Medical Staff at ILH. “The sooner you can get to definitive care, the better your outcomes are. In addition, it will allow us to care for patients in the hospital after they are admitted for trauma.”

Doubling in size, the trauma department expansion will include modernized respiratory equipment, new nurse support systems, new surgical and procedure tables, trauma carts and stretchers, and the capability to perform X-rays at the patient’s bedside.

“We will have special trauma beds so patients will not have to move to get their X-rays taken,” says Dr. McCabe. “This will allow us to take images quickly without causing pain or discomfort.”

“The purpose of the expansion is for patients to be treated in their community and not have to travel to Inova

Fairfax Hospital for tertiary care, unless necessary,” says ILH AVP and Chief Nursing Officer Lisa Dugan, Interim Chief Executive for Inova Health System. “We will now be able to evaluate and treat more orthopedic injuries, minor head injuries and more general surgery issues involving the spleen, liver and abdomen.”

Dugan is excited about the effect these improvements will have on the hospital’s overall quality of care. “As we develop and refine our skills and capabilities, we’re raising the standard of care and services available at every level. All of these efforts continue to elevate Inova Loudoun Hospital to be a much more advanced community hospital and it puts us on a path to becoming a tertiary care center,” says Dugan.

## WE’RE ALWAYS HERE

Inova Loudoun Hospital offers four convenient 24/7 ERs — and one specially designed and staffed just for kids:

- **Inova Loudoun Hospital Emergency Room**  
(44045 Riverside Parkway)
- **Inova Children’s Emergency Room at Inova Loudoun Hospital**  
(44045 Riverside Parkway)
- **Inova Emergency Room - Ashburn (HealthPlex)**  
(22505 Landmark Court)
- **Inova Emergency Room - Leesburg** (224 Cornwall St.)